

Yamaha G29/Adventurer Winch Mount Bumper Installation Instructions Part# 7453



*Always wear appropriate
eye protection!*



Installation Instructions:

1. Remove the stock bumper from the car.
2. Remove the bolts holding the stop bumper mounts to the car as shown in FIGURES 1 & 2. Discard the stock bumper mounts but save the bumper mount bolts for installing the new winch mount bumper.
3. Remove the stock front inner a-arm bolts from both the driver and passenger side of the car. Save these bolts for installing the new winch mount bumper. **NOTE: You may want to place a car jack under the frame of the front of the car to take the weight off the wheels. This will make it easier to remove the front inner a-arm bolts.**
4. Place the winch mount bumper in place with the bottom tabs on top of the frame where the stock bumper mounts bolted to the car. Securely tighten with the stock bumper mount bolts to both the driver and passenger side as shown in FIGURE 3.
5. Using the stock a-arm bolts securely tighten the winch mount bumper to the driver and passenger side upper a-arm brackets as shown in FIGURE 4.

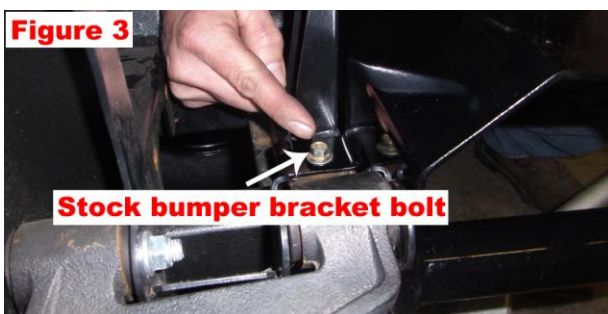
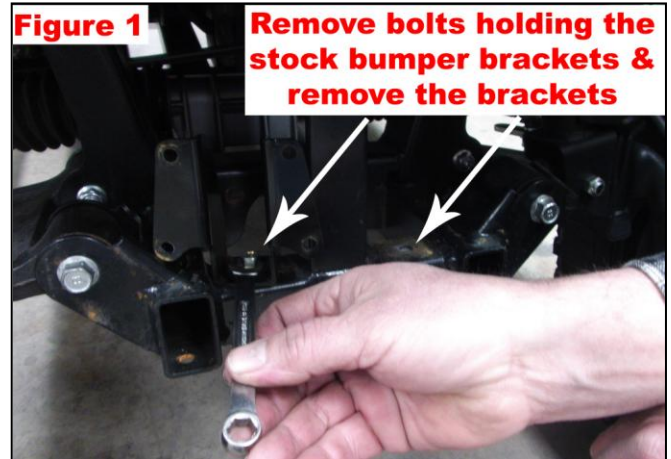

866-405-2537

www.jakesliftkits.com