



# BUGGIES UNLIMITED



## Rear Flip Seat Kit Installation Instructions for Yamaha® Drive® G29

### KIT INCLUDES:

Main Brackets



Footrest  
Brackets



Seat Back  
Brackets

Main Bracket Brace



Lean Back Cushion

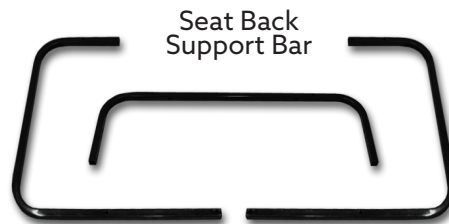

Seat Back  
Support Bar

Armrests



Seat Frame



Seat Bottom Cushion



Footrest



Bagwell Bracket



Tools Required: 5mm Allen Wrench & 13mm Socket

Switch the key to the OFF position and engage the Parking Brake.

Remove hardware from struts and take off canopy. Retain hardware and canopy.

**STEP 1**



4mm Allen Wrench

Remove hardware from rear struts to free gutters. Remove gutters by sliding them up and out of the rear body.

Retain hardware and gutters.

**STEP 2**



13mm Socket

Remove rear struts from front lean back cushion. Retain all.

**STEP 3**



10mm Socket or Wrench

Remove and retain the front lean back cushion.

**STEP 4**





Flat Head Screwdriver or Rivet Puller

Temporarily remove motor cover panel by popping out plastic rivets shown. Retain all.

**STEP 5**



12mm Socket

Take off basket by removing hardware located inside motor compartment. Retain hardware, discard basket.

**STEP 6**

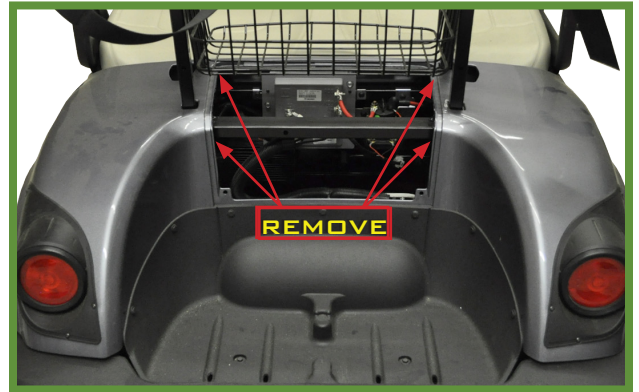

12mm Socket

Place new **Main Brackets** into basket mounts from STEP 6 and secure with retained basket hardware.

**STEP 7**



**Note:** Strut mounting tabs on brackets go to the outside of cart as shown.



13mm Socket

Attach factory rear struts to **Main Brackets** using hardware retained from Step 3.

**STEP 8**



Replace motor cover.



 13mm Socket

Attach **Main Bracket Brace** to **Main Brackets** using 8mm nylock nuts from Pack 1.

**STEP 9**



 10mm Socket

Attach front lean back cushion to **Main Brackets** using hardware retained from Step 4.

**STEP 10**



 10mm Socket

**A)** Cut plastic divider in bagwell if needed to allow Bagwell Bracket to sit flush in bagwell.

**B)** Remove factory bolts from bagwell.

**STEP 11**



 10mm Socket

Attach **Bagwell Bracket** using 6x30mm bolts, lock washers, & flat washers from Pack 1.

**STEP 12**



 17mm Socket & Wrench

**IMPORTANT:** Do not tighten the hardware until Step 20 is complete.

Attach **Seat Frame** to **Main Brackets** using the 10x25mm bolts from Pack 1.

**STEP 13**

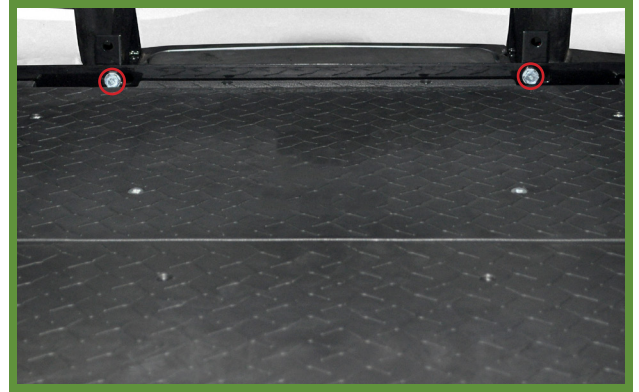

 17mm Socket & Wrench

Attach the **Seat Frame** to the **Bagwell Brackets** using 10x25mm bolts from Pack 1.

**STEP 14**

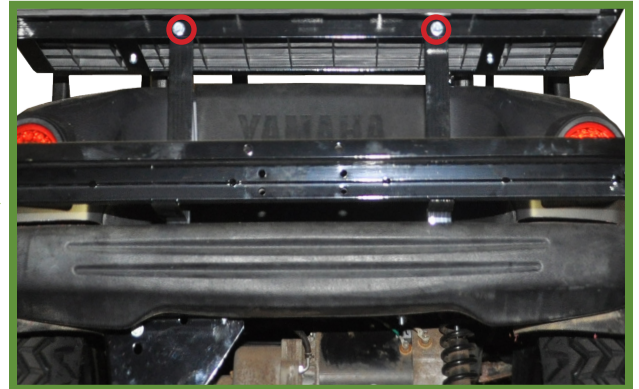

 17mm Socket & Wrench

Place **Seat Back Support Bar** in rear of **Seat Frame** as shown.

**A)** Using 10x70mm bolts and Rubber Spacers from Pack 2, attach the **Arm Rests** to the rear of the **Seat Frame** and **Seat Back Support Bar**.

**B)** Attach **Armrests** to the front of **Seat Frame** using the 10x45mm Countersunk bolts from Pack 2. Acorn nuts go to the outside of the cart.

 #3 Phillips Tip & 17mm Wrench

**STEP 15**

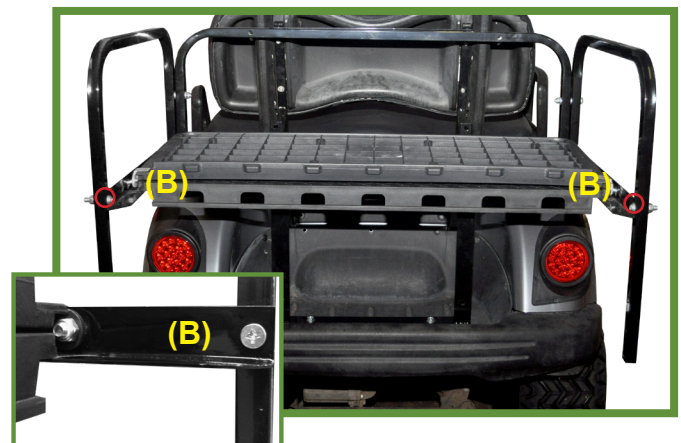
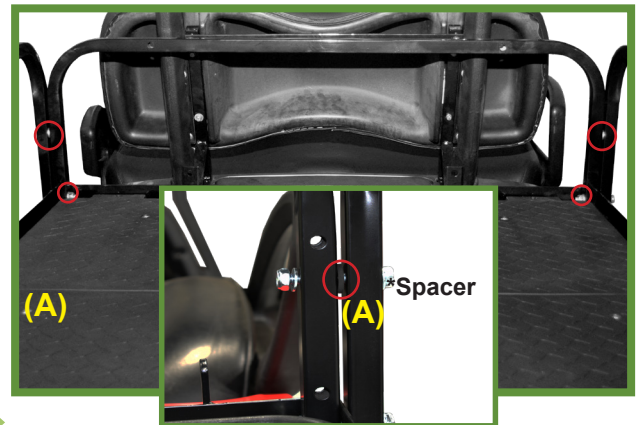



17mm Socket & Wrench

(A) Attach **Footrest to Bagwell Bracket** using 10x25mm bolts from pack 3.

(B) Attach **Footrest Brackets to Footrest and Armrest** using 10x70mm bolts from Pack 3.

**STEP 16**

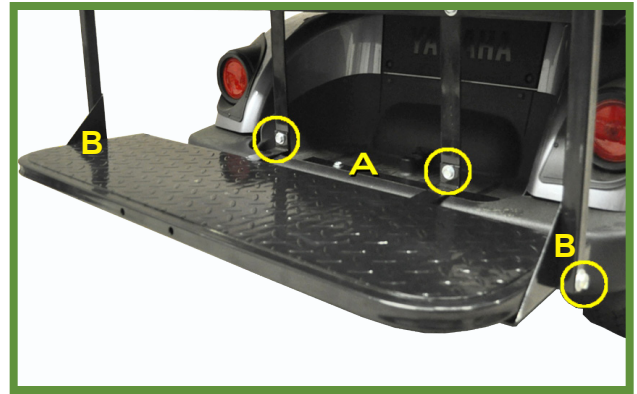

10mm Socket

Attach **Seat Back Brackets to Lean Back Cushion** using hardware from Pack 4. Tighten hardware.

**STEP 17**



17mm Socket & Wrench

Attach **Lean Back Cushion w/ brackets to Seat Back Support Bar** using 10x45mm bolts from Pack 5.

**STEP 18**



#3 Phillips Tip

1. Insert the supplied Nylon seat strap between flip frame and cushion at desired location.

2. Make sure the thickest part of the seat bottom is towards the rear. Center seat bottom from left to right on flip frame. Using countersunk bolts from Pack 5, tighten the seat bottom to seat frame as shown.

**STEP 19**

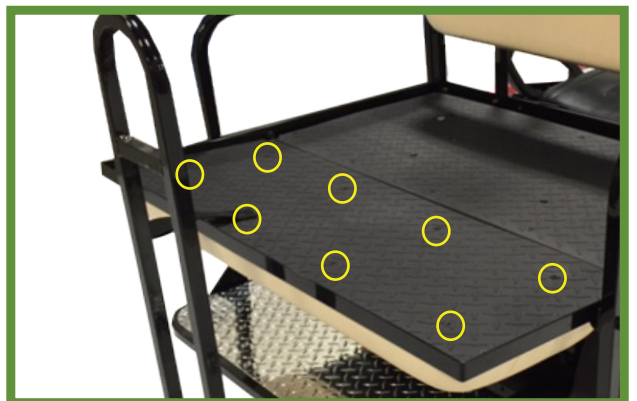

\*Grab Bar not included\*





5mm Allen Wrench & 13mm Wrench

Reattach canopy using hardware retained from Step 1.

**STEP 20**



**INSTALLATION COMPLETE**

## HARDWARE PACK

---

### **Pack 1**

- 4 - 10x25mm Hex Bolt
- 8 - 10x20mm Flat Washer
- 4 - 10mm Nylock Nut
- 2 - 8mm Nylock Nut
- 2 - 6x30mm Hex Bolt
- 2 - 6mm Flat Washer
- 2 - 6mm Lock Washer

### **Pack 2**

- 4 - 10x70mm Hex Bolt
- 2 - 10x45mm Countersunk Bolt
- 10 - 10x20mm Flat washer
- 4 - 10mm Nylock Nut
- 2 - 10mm Acorn Nut
- 2 - Rubber Spacer

### **Pack 3**

- 2 - 10x70mm Hex Bolt
- 2 - 10x25mm Hex Bolt
- 8 - 10mm Flat Washer
- 4 - 10mm Nylock Nut

### **Pack 4**

- 4 - 6x20mm Hex Bolt
- 4 - 6mm Lock Washer
- 4 - 6x17mm Flat Washer

### **Pack 5**

- 2 - 10x45mm Hex Bolt
- 4 - 10mm Flat Washer
- 2 - 10mm Nylock Nut
- 8 - 8x30mm Countersunk Bolt
- 1 - Nylon Strap



# **BUGGIES**

## UNLIMITED

Yamaha®, G-14®, G-19®, G-22®, G-29® are registered trademarks of Yamaha Golf-Car Company and Yamaha Motor Corporation (“Yamaha”). Reference to Yamaha’s trademarks and products is only for purposes of identifying golf carts with which this Buggies Unlimited product is compatible. Buggies Unlimited products are aftermarket parts and are not original equipment parts. Buggies Unlimited is not connected or affiliated with or sponsored by Yamaha Motor Corporation or Yamaha Golf-Car Company.