



780 Professional Drive N. Shreveport, LA 71105 Phone (318)-524-2270 Fax (318)-524-2297

MCRRA-P1SCR

Max Clearance Polaris Sportsman/Scrambler Rear Raked Control Arm Kit

Read before Installation

This product is designed for use on ATVs and/or RUVs to increase ground clearance and fender clearance. Purchasers should be aware that use of this product may increase the frequency of required maintenance, part wear, and will raise the center of gravity on your ATV and/or RUV, increasing risk of roll-over, injury and death on all types of terrain. It is your responsibility to always inform other operators and passengers of this vehicle about the added risks.

High Lifter Products, products are designed to best fit users ATV/RUV under stock conditions. Adding, modifying, or fabricating any OEM or aftermarket parts will void warranty. High Lifter Products, products could interfere with other aftermarket accessories. If the user has aftermarket products on machine, contact High Lifter Products to verify that they will work together. Adding aftermarket suspension components and/or more aggressive tires can cause breakage of other OEM driveline components such as differentials, axles or drive shafts.

We recommend that wider tires and/or wheel spacers be used to achieve a wider stance and to improve stability of the ATV and/or RUV. Riders should be advised that the handling characteristics of a taller ATV and/or RUV are different and require extra care when riding, particularly on side hills or off-camber situations. If you further raise the center of gravity by adding taller tires, heavy loads to racks or seats, or by any other means, the ATV and/or RUV must be operated with even more care, at slower speeds and on relatively flat ground. All turns should be done at a slow speed, even on level ground.

Operation of an ATV and/or RUV with or without modified suspension components, while or shortly after consuming alcohol or drugs, subjects the rider to the risk of serious bodily harm or possible death. This risk is compounded if the rider does not wear an approved helmet and other safety gear. High Lifter urges that all approved safety gear be worn when riding an ATV and/or RUV as a driver or passenger.

By purchasing and installing High Lifter Products, products, user agrees that should damages occur, High Lifter Products will not be held responsible for loss of time, use, labor fees, replacement parts, or freight charges. High Lifter Products will not be held responsible for any direct, indirect, incidental, special, or consequential damages that result from any product purchased from High Lifter Products. The total liability of seller to user for all damages, losses, and causes of action, shall not exceed the total purchase price paid for the product that gives rise to the claim.

If this product is not what you expected, or is not consistent with your intended use, you should return the product immediately to the seller, before installation, for a refund of the purchase price; less any fees. After installation, product is warranted for 90 days for defects in workmanship and materials. High Lifter Products will warranty only parts provided by High Lifter Products. Any damage or problems with OEM housings, bearings, seals, or other manufacturer's products will not be covered by High Lifter Products. Parts and products will not be warranted if item was not installed properly, misused, or modified.

Dealers and other Installers

You are responsible for informing your customer and end user of the information contained above and the increased potential hazards of operating an ATV and/or RUV equipped with modified suspension components. If you install any suspension modifying components, it is your responsibility to also install the warning label prominently in view of the driver and in prominent view of the driver and passenger on RUVs and multi-passenger ATVs. They should also be instructed to notify anyone operating the vehicle, as well as any passengers, that said vehicle is modified.

As discussed above, it is critically important that they be instructed in the need for slower speed operation, regardless of terrain, after this kit is installed.

Parts Diagram



NOTE: If your ATV is equipped with rear arched control arms from the factory, then you will need to remove the factory sway bar when you install the High Lifter Rear Racked control arm kit. It cannot be used in conjunction with the High Lifter Rear Racked control arm kit.

Installation Instructions

- 1) Place jack under the rear center and lift until the weight is off the suspension. Be careful to secure properly so that it is stable on the jack.
- 2) Remove the rear wheels.
- 3) Disconnect the sway-bar link from the control arm on both sides of the ATV.
- 4) NOTE: If your ATV is equipped with rear arched control arms from the factory, then you will need to remove the factory sway bar when you install the High Lifter Rear Racked control arm kit. It cannot be used in conjunction with the High Lifter Rear Racked control arm kit.
- 5) Remove the rear upper and lower control arms from both sides. Disconnect from frame and rear hubs.



- 6) Remove the stock bushing and sleeves from the factory arm and insert them into the new rear control arms.

Note: Placing some grease on the bushing and sleeves. This makes the installation easier.

- 7) Once you have removed the stock bushings, sleeves, and ball joints from the factory arms install them into the new arms in the kit. If you place some grease on them it makes the installations easier
NOTE: The upper control arms use the 90 grease fittings and the lower control arms use the straight grease fittings.

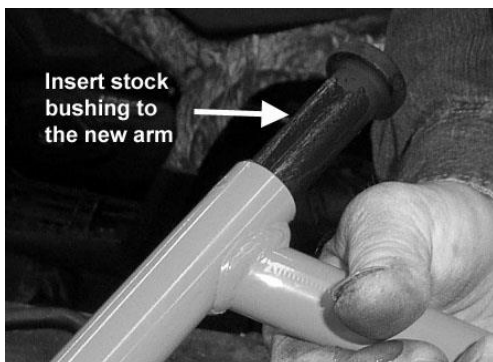
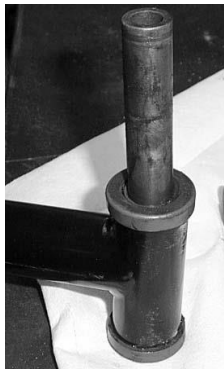

- 8) When the bushing and sleeves are in place connect the new control arms to the frame using the stock hardware. Start with the upper arm first then do the lower arm at the frame.

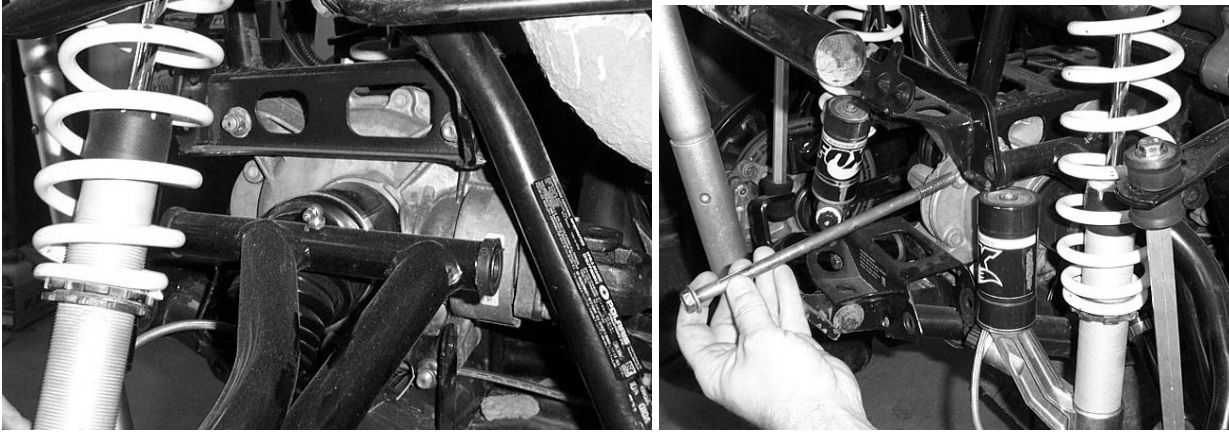

- 9) Next connect the upper arm to the knuckle assembly using the factory hardware.

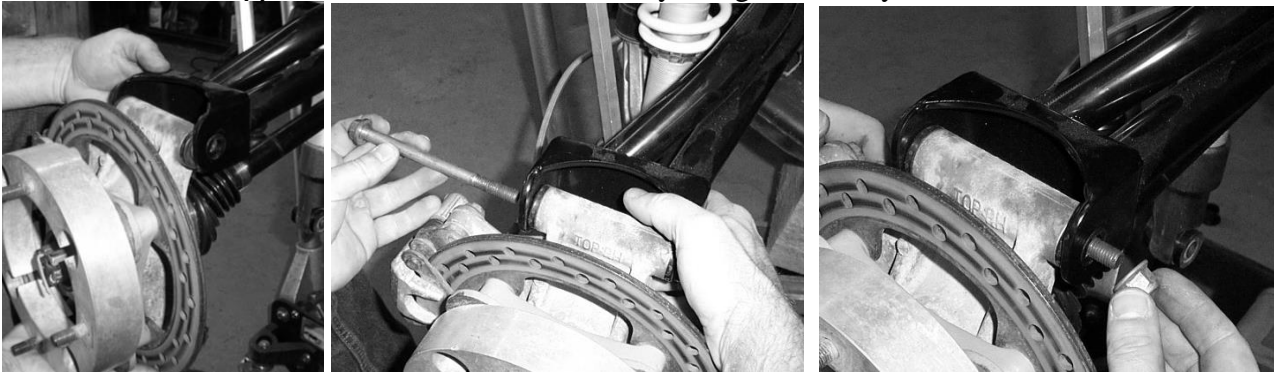

- 10) Connect the lower control arm to the frame using the factory hardware.

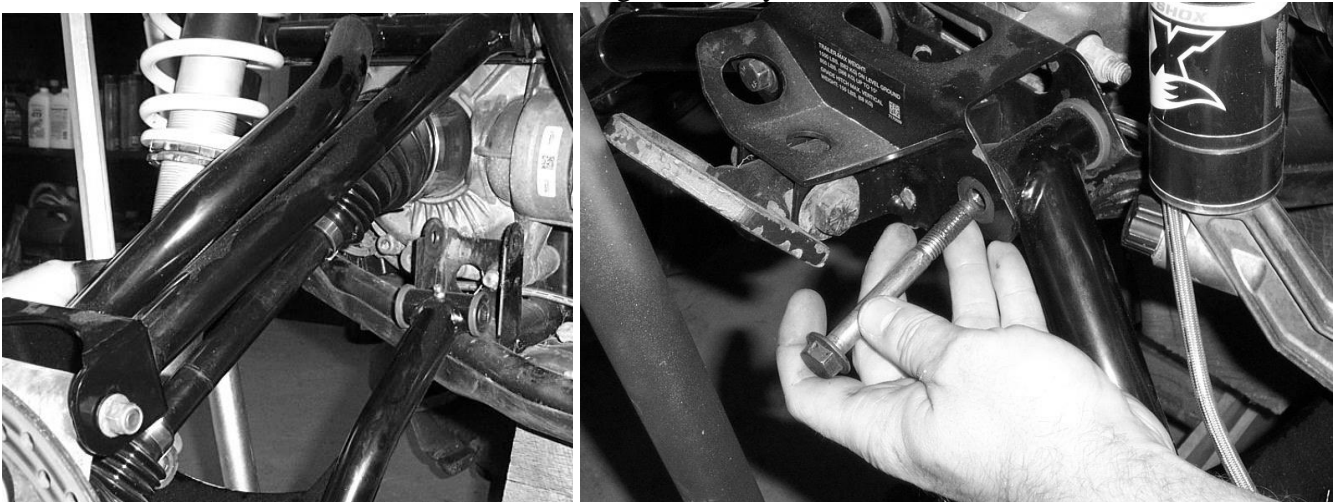

- 11) Connect the lower control arm to the knuckle assembly. Replace the bolt that connects the lower control arm to the hub assembly. Use the 10mm x 150mm bolt and 10mm lock nut provided in the kit.

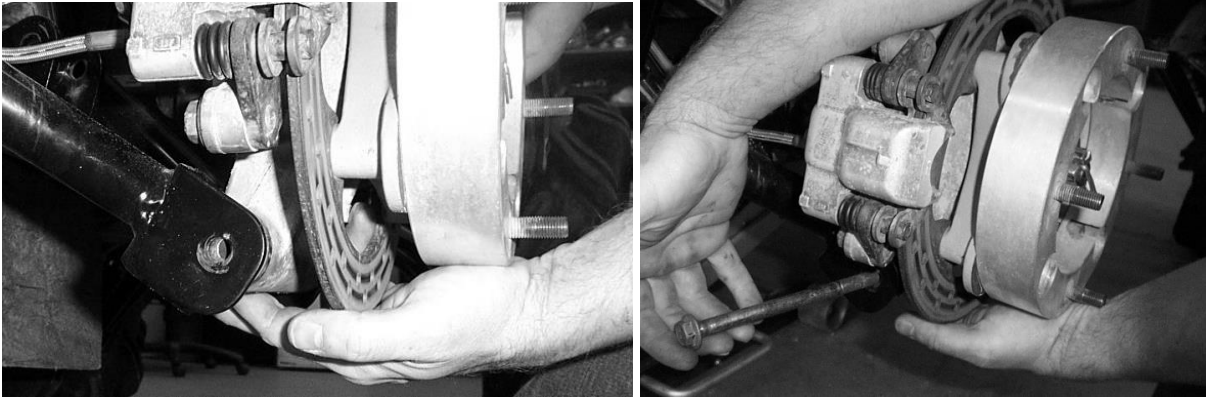

- 12) Connect the bottom of the shock to the control arm using a 10x65mm bolt and 10mm lock nut

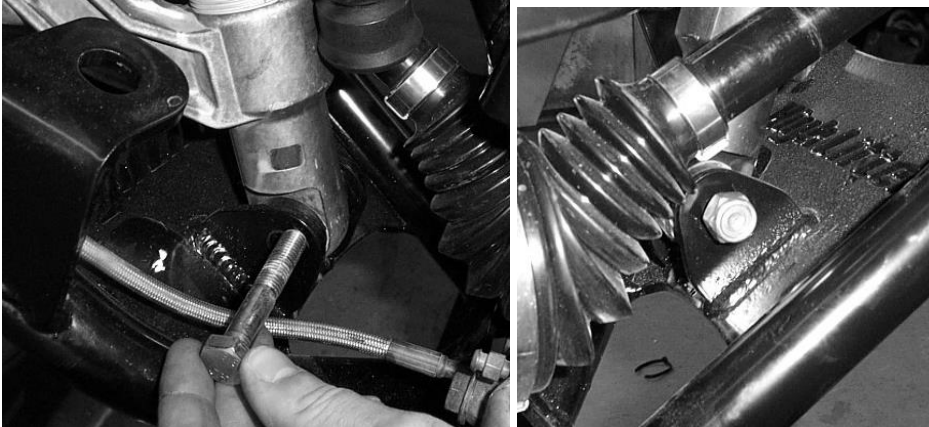

- 13) NOTE: If your ATV is equipped with rear arched control arms from the factory, then you will need to remove the factory sway bar when you install the High Lifter Rear Racked control arm kit. It cannot be used in conjunction with the High Lifter Rear Racked control arm kit. This is if your ATV comes from the factory with arched arms!!

- 14) Reconnect the sway-bar links to the control arm using the factory hardware.

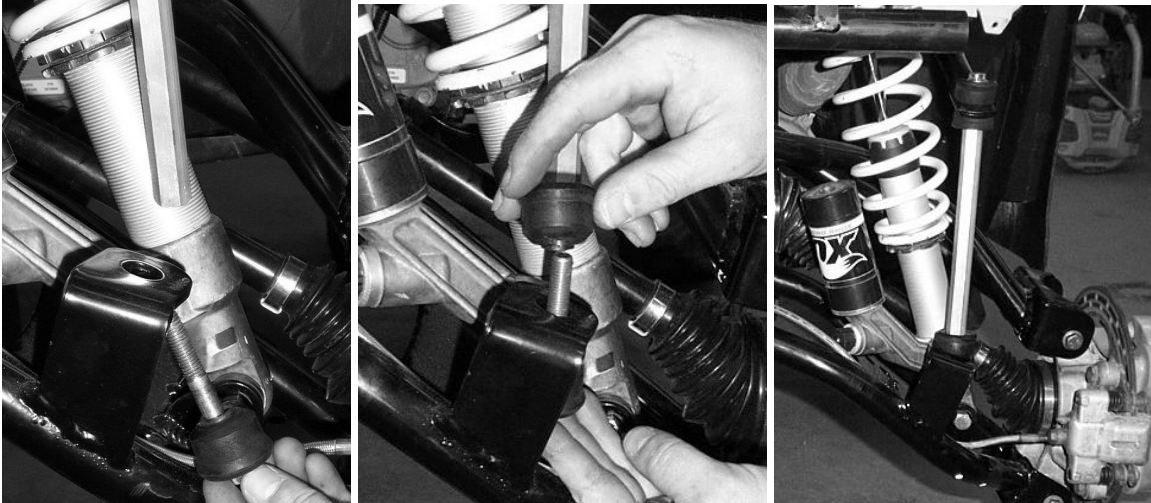

NOTE: To make installing the sway-bar link easier you can loosen the top of the line to give you more in the adjustment so you can connect it to the lower arm.

15) Secure the brake lines to the new are using the zip ties provided in the kit.

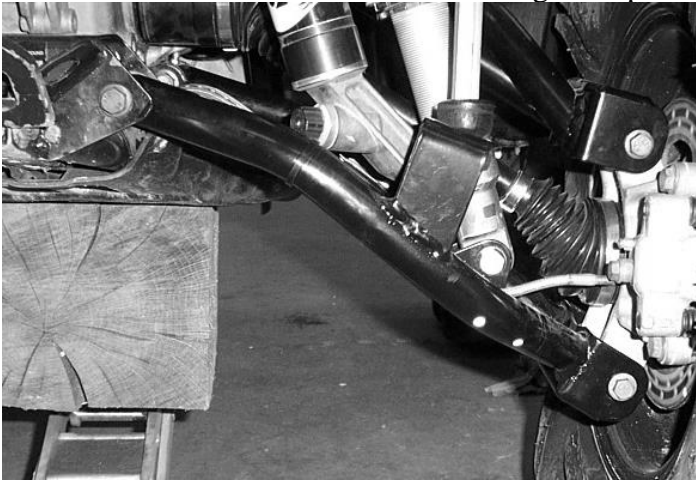

16) Repeat steps for opposite side.

17) Once you have installed the control arms, place the wheels back on the UTV. Torque all lugs to factory specifications and lower the jack.

Thank You
For choosing
HighLifter
PRODUCTS



High Lifter Lifetime Warranty

From the beginning, High Lifter has engineered and manufactured some of the toughest, most durable products on the market. That's why this product comes with a Lifetime Warranty. It's our promise that High Lifter will never let you down.

- The **Lifetime Warranty** covers products sold to the original purchaser only and is not transferable. The term of the warranty is for the lifetime of the vehicle in question.
- Normal wear and tear items and finishes, such as, but not limited to: Heim joints, tie rod ends, ball joints, bearings, seals, bushings, bushing sleeves, zinc plating , powder coating, or chipping and discoloration of any finish is not covered.
- High Lifter will ship the replacement product after the returned product has been inspected by High Lifter staff.
- The warranty shall not include claims for damages, installation time or labor charges, economic losses, inconvenience, transportation, towing, down time, direct or indirect or consequential damages or delay resulting from any defect.
- The warranty does not apply to products that have been improperly applied or improperly installed.

Making a warranty claim

1. All claims must be accompanied by the part and the original sales receipt or other acceptable proof of purchase from the original owner.
2. All warranties must be accompanied with a Return Merchandise Authorization (RMA) number. (Contact High Lifter at 318-524-2270 or 800-699-0947 for an RMA number)
3. When shipping the damaged product:
 - a. Write the RMA number on the outside of the box.
 - b. Also include the RMA number, proof of purchase and any notes inside the box.
 - c. Please keep your tracking number and shipment information.
4. The customer is responsible for shipping the product to High Lifter--return shipping within the lower 48 states will be paid by High Lifter products. With all warranty claims, only standard shipping services apply.
5. High Lifter will process your order within 24 business hours of receiving the returned item.
6. **Ship to:** High Lifter Products, 780 Professional Drive North, Shreveport, Louisiana 71105